

PANEL MOUNTING

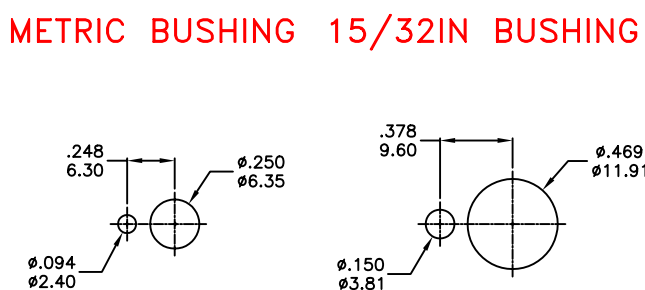
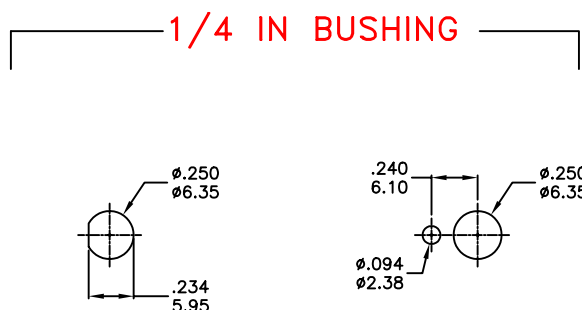
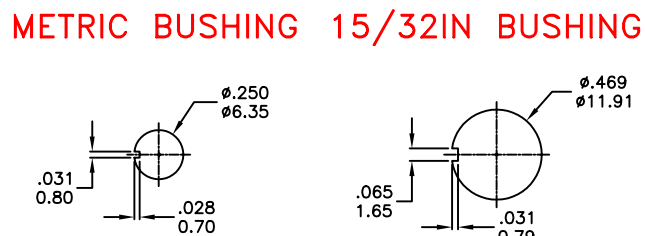
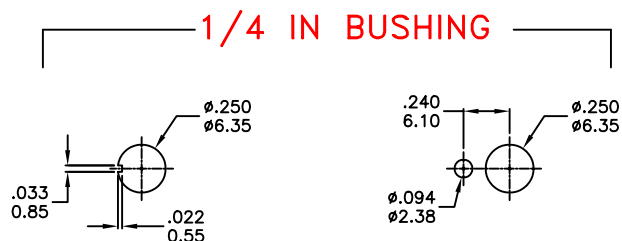

CONTACT MATERIAL OPTIONS

Q =Silver	<u>Q.C.S.K</u>	<u>R.G</u>
R =Gold		
G =Gold,tin-lead	FIXED TERMINAL: Silver plated over copper alloy	FIXED TERMINAL: Copper alloy with gold plated over nickel plated
S =Silver,tin-lead	MOVABLE CONTACT: Silver plated over copper alloy	MOVABLE CONTACT: Copper alloy with gold plated over nickel plated
C =Gold over silver	RATING: 5 Amps with resistant load @ 120VAC or 28VDC 2 Amps with resistant load @ 250VAC	RATING: 0.4 Volt-Amps(VA)max. @ 20V max. (AC or DC)
K =Gold over silver ,tin-lead		